



## 733 Marsh Street, Suite B

### **Property Description:**

Location: San Luis Obispo, California

Size: 2157 Square Feet

Price: \$1.85/SF, NNN

Type: Professional Office

Parking: On-Site

Notes: Newly constructed office space located downtown with on-site parking. This ground floor suite has a prominent corner entrance and a functional floor plan. Other tenants in the project include; Charles Schwab, Coast Hills Credit Union, Bank of Commerce, and Exact Bid.

MARK ANDERSON

805.543.1400  
798 PALM ST, SLO, CA 93401  
[AndersonCommercialRE.com](http://AndersonCommercialRE.com)  
DRE #00944530

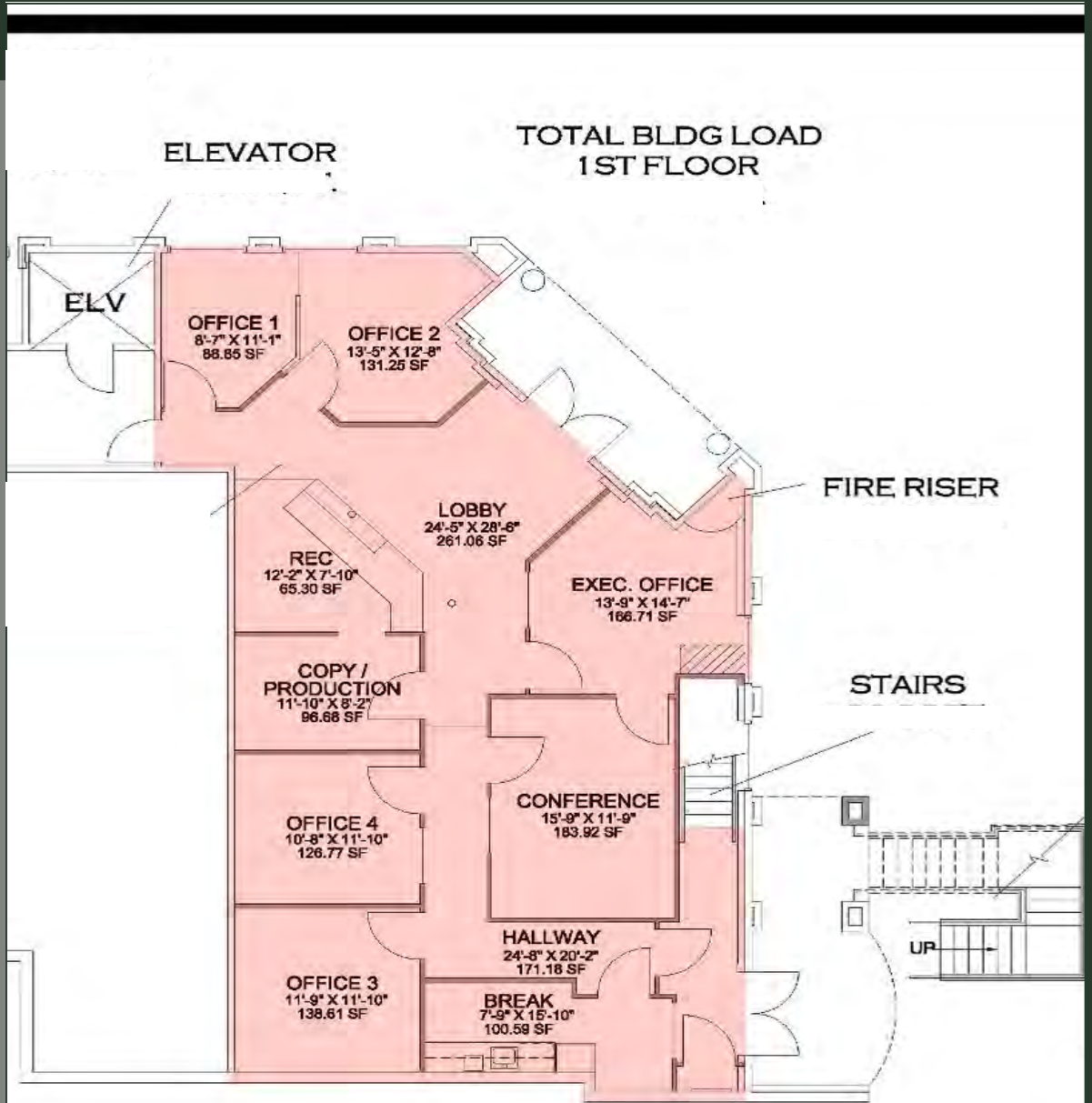

BASE VERSION DATE: 4.12.11 TIME: 2:00

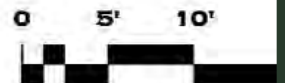
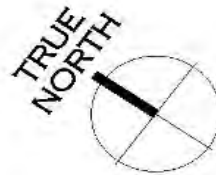

**MARK ANDERSON**

805.543.1400  
798 PALM ST, SLO, CA 93401  
[AndersonCommercialRE.com](http://AndersonCommercialRE.com)  
DRE #00944530

# ANDERSON COMMERCIAL REAL ESTATE SERVICES

# IMAGES & AERIAL VIEW



MARK ANDERSON

805.543.1400  
798 PALM ST, SLO, CA 93401  
[AndersonCommercialRE.com](http://AndersonCommercialRE.com)  
DRE #00944530